

# BELOW

## | LOBBY |

### EXECUTIVE JUNCTION

Well-designed function rooms fully equipped with high-quality amenities and with an open event kitchen, for up to 120 guests.

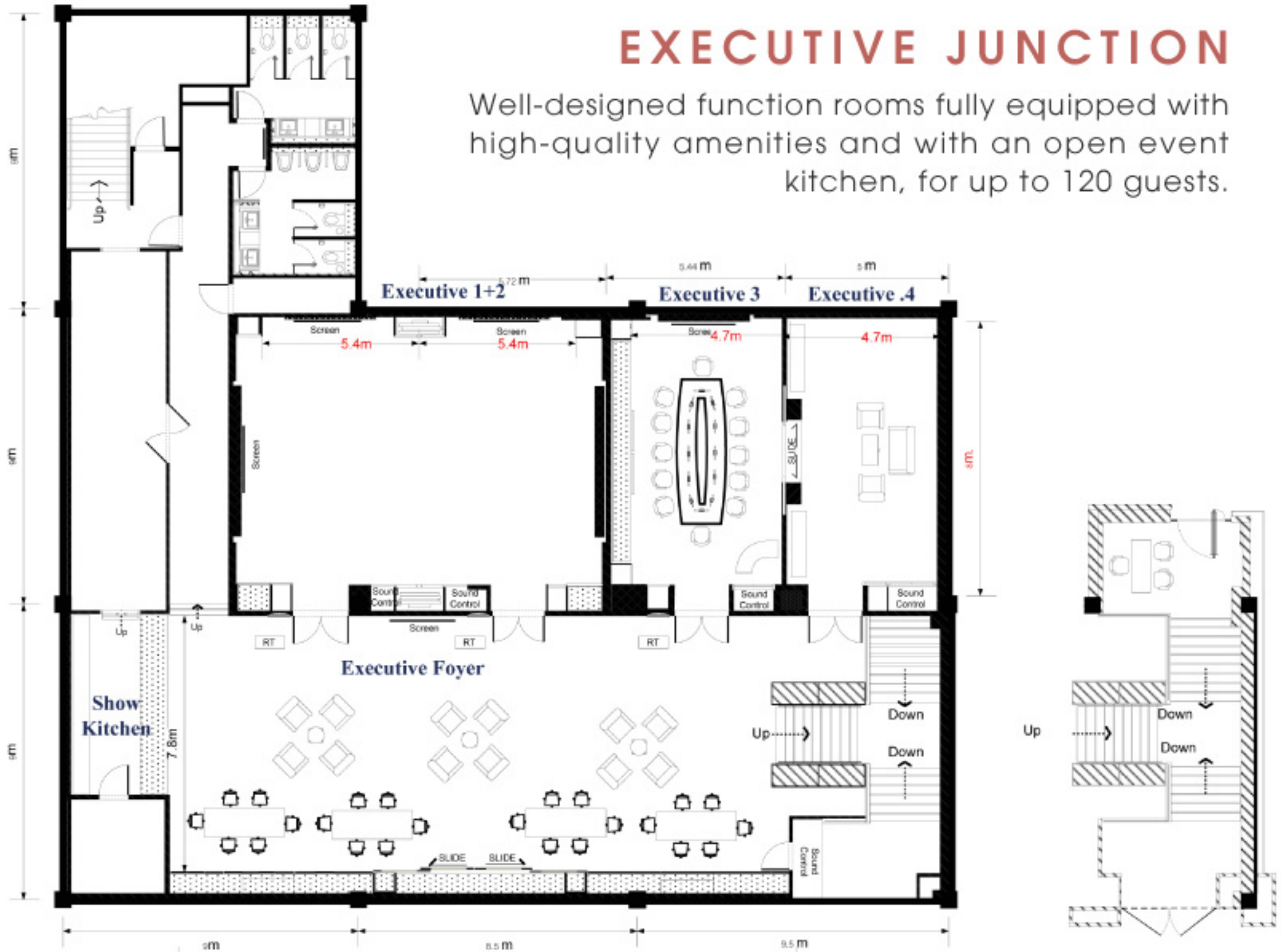

### Below-Lobby

Meeting Room	Dimensions (m) (W. x L. x H.)	Sq.m	Banquet / Event		U-shape (Pax)	Classroom (Pax)	Theater (Pax)
			Banquet (Pax)	Cocktail (Pax)			
Executive 1	5.4 x 8 x 3.1	43.2	20	30	18	21	40
Executive 2	5.4 x 8 x 3.1	43.2	20	30	18	21	40
Executive 1+2	10.8 x 8 x 3.1	86.4	50	80	30	50	80
Executive 3+4	4.7 x 8 x 3.1	37.6	n/a	n/a	14	n/a	n/a
Executive Foyer	8 x 18 x 3.4	144	80	120	n/a	n/a	n/a





C l a s s r o o m



B o a r d r o o m

## FOYER

Expansive foyer area, perfect for coffee breaks, receptions and evening cocktail parties.





## COFFEE BREAKS

We offer flexible, high quality coffee breaks that include:

- A large array of sweets & savory selections for both morning and afternoon breaks, freshly prepared by our talented in-house bakery.
- Live stations that can be tailored specifically to your preference.
- Freshly brewed coffee, classic and herbal tea selections, and freshly squeezed juices.



M Floor



8<sup>th</sup> Floor



Below - Lobby



## LUNCH BUFFETS

**Meeting packages include a number of lunch options:** International buffets at CiTi BiSTRo, featuring Thai and Western dishes, carving station, sashimi and more. *(Minimum 30 guests).*



An Italian buffet at our 8<sup>th</sup> Floor Terrazza Restaurant for up to 60 people featuring authentic Italian classics including antipasti, pizza and pasta dishes.

## BUSINESS LUNCH SETS

For smaller groups we offer a more intimate experience with business lunch sets available in Kongju Korean Restaurant, Terrazza Italian Restaurant and CiTi BiSTRo.

